

System 106
Intercom module

GIRA

5563 9..

10864529 40/16

General safety instructions



Electrical devices may only be installed and connected by a qualified electrician!

These instructions are part of the product and must remain with the end customer.

Necessary accessories

- System 106 call-button module (Item no. 555 ...).
- Audio control device (Item no. 1287 00).
- System 106 call-button module, 1-gang to 4-gang (Item no. 5531 9.., 5532 9.., 5533 9.., 5534 9..).
- Gira home station.
- System 106 surface-mounted housing, 1-gang to 5-gang (Item no. 5501 ..., 5502 ..., 5503 ..., 5504 ..., 5505 ...).

Accessories

- System 106 button module, 1-gang to 4-gang (for extension from 4-gang button module).
- Power supply for door communication DC 24 V 300 mA (Item no. 1296 00) for additional power supply (ZV).

Functional description

The intercom module is the central module in the Gira door communication system 106. The module provides the intercom function as well as the power supply of all other modules connected to the intercom module. In addition, the intercom module switches the backlighting of the connected call-button modules on or off, dependent on ambient light conditions.

Scope of supply

- 1 x System 106 intercom module
- 1 x operating instructions

Check that the package contents are complete and undamaged. When filing complaints, see "Warranty".

Device description

Front view

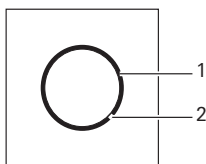

- 1 Microphone and loudspeaker aperture
- 2 Status LED

Rear view

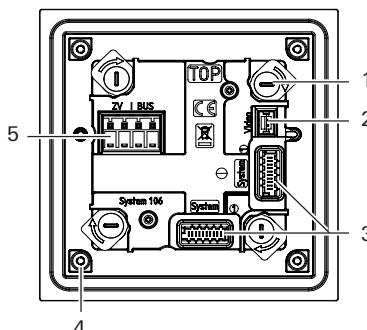

- 1 Turn-type lock (4 x)
- 2 Slot: video
- 3 Slot (2 x): System cable
- 4 Mounting (4 x): Module front
- 5 Plug terminal: Power supply (BUS) and additional supply (ZV)

Installing the module



Installing the module

The following work steps can be found in the installation instructions for the System 106 surface-mounted housing, 1-gang to 5-gang:

- Lock module on function carrier.
- Connect system cable.
- Connect terminating resistances.



Terminating resistance

Two terminating resistances are included from surface-mounted housing, 2-gang. The terminating resistances are always attached to the first and last module on the system cable.



Installation position of plug terminal

Observe the correct installation position (reversed) for the plug terminal.

Start-up of the module

The intercom module can only be started up via the control device when connected to a call-button module (see installation and operating instructions of the control device). For a successful start-up, all other devices (System 106 modules, home stations, control device, etc.) must have been previously installed.

Configuring the module

Volume control

The volume is controlled at the call-button module (see call-button module operating instructions).

Switching acoustic call-button actuation on or off

Acoustic call-button actuation is switched on or off at the call-button module (see operating instructions for call-button module).

All acknowledgement tones continue to sound in activated programming mode.

Status LED

LED	Meaning
Flashes orange	Programming mode active
Lights up red continuously	Failure of additional supply, system bus short circuit or low voltage or voltage of additional supply > 30 V
Flashes green for short period of time	Acknowledgement when button is pressed

Changing the module front

1. Open housing and remove the function carrier.
2. Unlock intercom module and remove from function carrier.
3. Remove mounting screws and then remove the module front including seals.

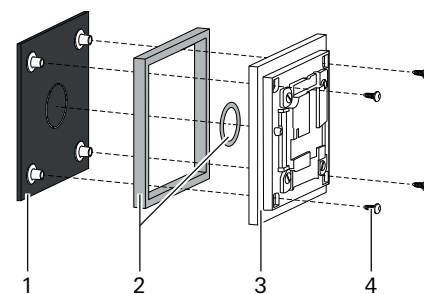

- 1 Module front
 - 2 Seals
 - 3 System 106 intercom module
 - 4 Mounting screws (4 x)
4. Position new module front with new seals and assemble in reverse order.

Technical data

Power supply:	via control device or via additional power supply (DC 24 V 300 mA)
Voice connection power consumption:	approx. 1.0 W
Stand-by mode:	200 mW
Connections:	2 x 2-wire bus 2 x additional supply 2 x system 1 x video
Ambient temperature:	-25 °C to +70 °C
Protection type	IP54
Dimensions (W x H):	106.5 x 106.5 mm

Warranty

The warranty is provided in accordance with statutory requirements via the retailer. Please submit or send faulty devices postage paid and with an error description to your sales representative (retailer/ installation company). The salesperson will forward the devices to the Gira Service Center.

Gira

Gira
Giersiepen GmbH & Co KG
Electrical installation systems
P.O. Box 1220
42461 Radevormwald
Phone: +49 (0) 2195 602 - 0
Fax: +49 (0) 2195 602 - 191
info@gira.de
www.gira.de